

AJC 空壓治具缸 SW. SWM



Air Jig Cylinder SW. SWM

• Bore: $\phi 20$ - $\phi 100$ mm • Pmax: 10kg/cm²

Bore $\phi 20$ - $\phi 25$

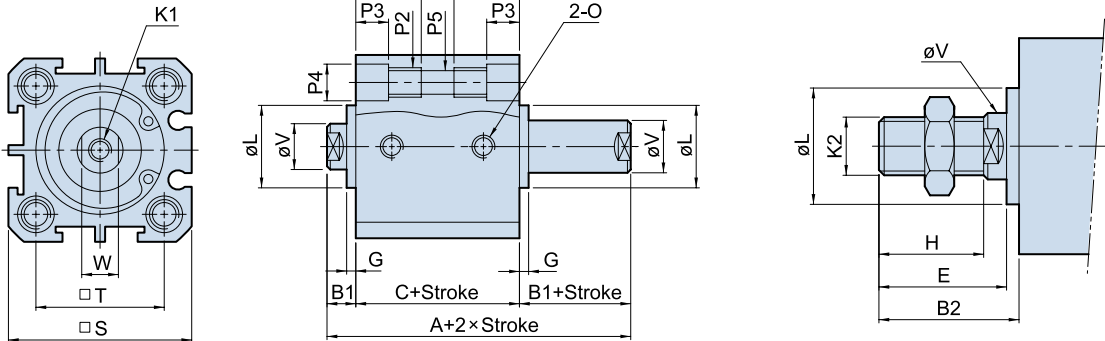

Bore $\phi 32$ - $\phi 100$

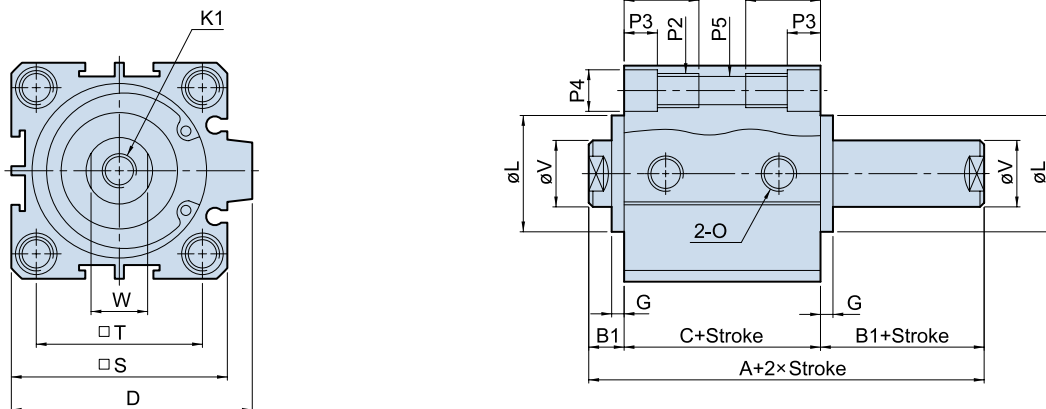

Dimensional table

UNIT:mm

Bore	AJC-SW		AJC-SWM		B1	B2	D	E	G	H	K1内牙 Int. thread K1
	A	C	A	C							
$\phi 20$	30.5	19.5	40.5	29.5	5.5	19.5	—	18	1.5	14	M4 x 0.7 x 10D.
$\phi 25$	33	21	43	31	6	22	—	20	2	16	M5 x 0.8 x 10D.
$\phi 32$	38.6	24	48.6	34	7.3	24.3	50	21	3.3	17	M6 x 1.0 x 14D.
$\phi 40$	41.1	26.5	51.1	36.5	7.3	34.3	58	31	3.3	27	M8 x 1.25 x 14D.
$\phi 50$	46.6	28.6	56.6	38.6	9	36	71	32	4	27	M10 x 1.5 x 15D.
$\phi 63$	50.5	32.5	60.5	42.5	9	36	84.5	32	4	27	M10 x 1.5 x 15D.
$\phi 80$	63.3	41.3	73.3	51.3	11	44	104	39	5	33	M14 x 1.5 x 20D.
$\phi 100$	62.3	45.3	72.3	55.3	8.5	41.5	124	38.5	3	33	M16 x 2.0 x 20D.

Bore	K2外牙 Ext. thread K2	L	O	P1	P2	P3	P4	P5	S	T	V	W
$\phi 20$	M6 x 1.0	13	M5 x 0.8	11	M5 x 0.8	5	$\phi 6.5$	$\phi 4.3$	34	24	8	6
$\phi 25$	M8 x 1.25	17	M5 x 0.8	14	M6 x 1.0	6	$\phi 8$	$\phi 5.1$	40	28	10	8
$\phi 32$	M10 x 1.25	22	PT1/8	14	M6 x 1.0	6	$\phi 8$	$\phi 5.1$	44	34	12	10
$\phi 40$	M14 x 1.5	28	PT1/8	18	M8 x 1.25	8	$\phi 9.5$	$\phi 6.8$	52	40	16	14
$\phi 50$	M18 x 1.5	38	PT1/4	18.5	M8 x 1.25	8.5	$\phi 11$	$\phi 6.8$	62	48	20	17
$\phi 63$	M18 x 1.5	40	PT1/4	18.5	M8 x 1.25	8.5	$\phi 11$	$\phi 6.8$	75	60	20	17
$\phi 80$	M22 x 1.5	45	PT3/8	22.5	M12 x 1.75	10.5	$\phi 14$	$\phi 10.5$	94	74	25	22
$\phi 100$	M22 x 1.5	45	PT3/8	28	M14 x 2.0	13	$\phi 18.5$	$\phi 12.3$	114	90	25	22